

STELLA

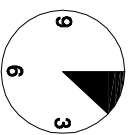

50 min.

- (D)** Montageanleitung
- (FR)** Notice de montage
- (NL)** Handleiding voor de montage
- (CZ)** Montážní návod
- (HU)** Szerelési útmutató
- (TR)** Montaj talimatı
- (GB)** Assembly Instructions
- (IT)** Istruzioni di montaggio
- (PL)** Instrukcja montażu
- (SK)** Návod na montáž
- (RO)** Instrucțiuni de montaj
- (RU)** Инструкции по монтажу

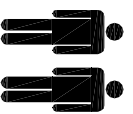
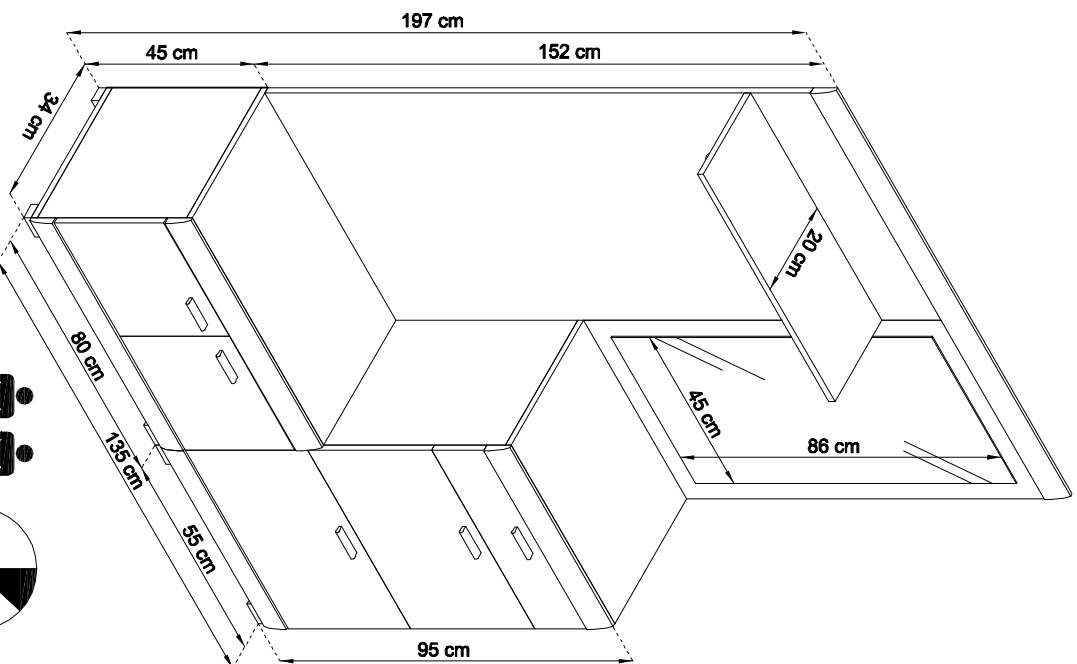
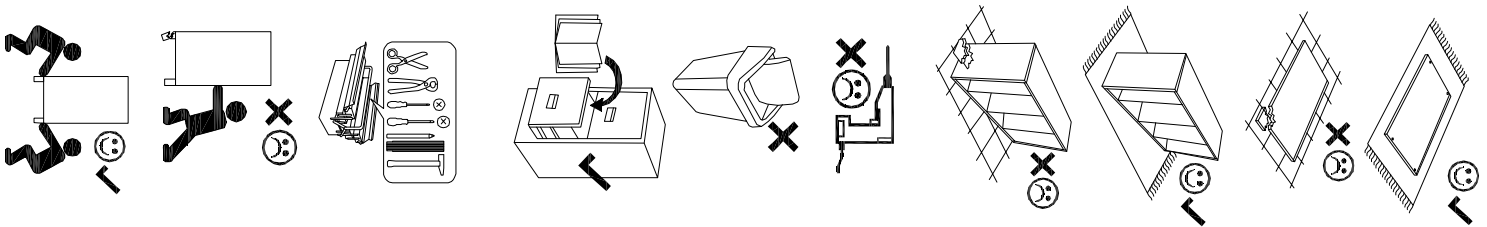
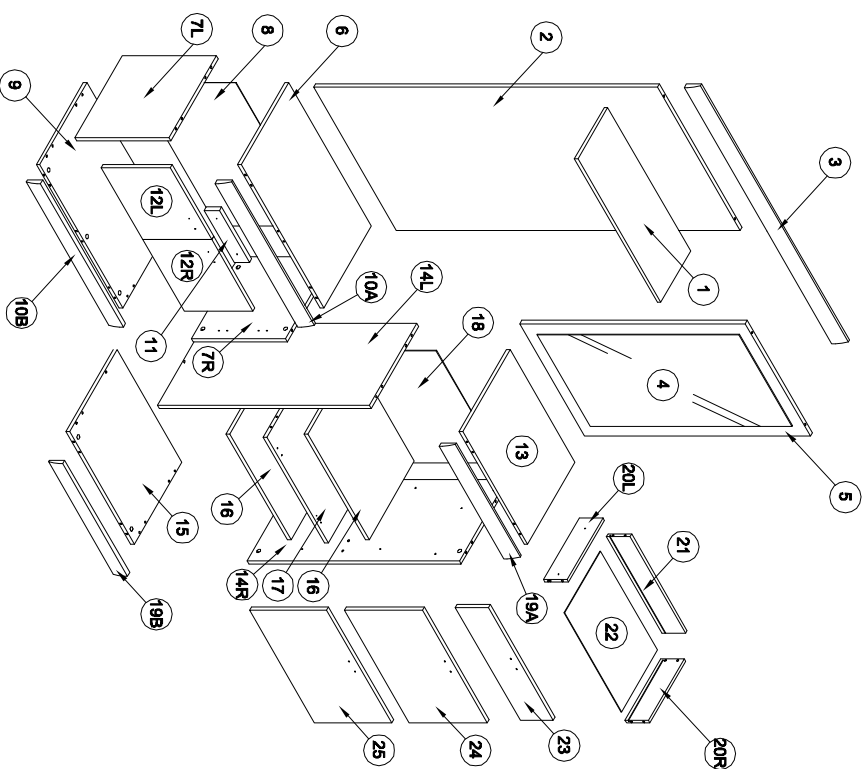

PPW X2 	V 3x13 X6 	NF 4x30 X2 	TB X1 	TA X1 	K3 4x25 X16 	YD 7x60 X3 	BL X3
C X34 	Z X34 	Y X8 	PR X2 	H 6,3x13 X1 	Z X1 	RR 1/2 X4 	ND 3,5x16 X8
B X34 	A 6x32 X30 	RC X4 	N 3x20 X34 	M1 X5 	RCZ X2 	NA 4x13 X17 	PC X4
O X2 	P X2 	HK X3 	GLUE X1 	WB X16 X1 	X4 X3 	HA 5x9 X3 	



Увага • Urozorníni • Achtung • Attention • Caution • Figyelem
Attenzione • Orgetlet • Внимание • Ateñje • Urozornenie • Dikkat

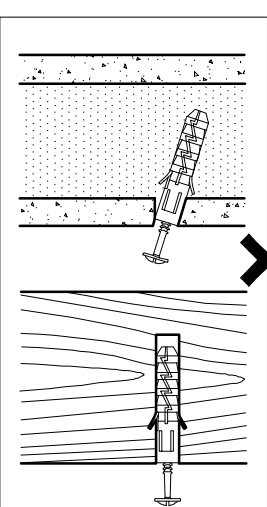
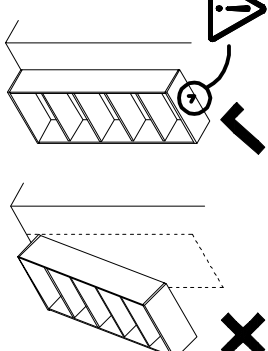
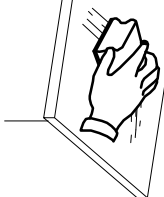
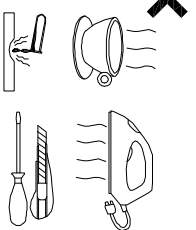
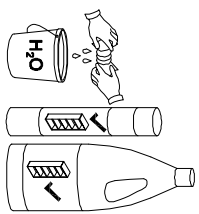
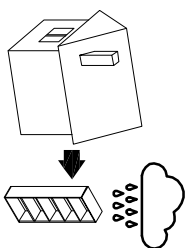
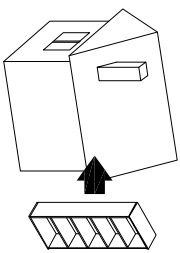

PL	Czyszczenie należy wykonać wyłącznie za pomocą ściereczki lub lekko nawilżonego ręcznika. Nie stosować środków czyszczących do szorowania.
CZ	Čištění je nutné vykonávat výhradně pomocí utěrky nebo lehkce navlhčeného ručníku. Nepoužívejte čisticí prostředky obsahující abrazivní částice.
DE	Bitte nur mit einem Staubtuch oder leicht feuchtem Lappen reinigen. Keine scheuernden Putzmittel verwenden.
GB	Please only clean with a duster or damp cloth. Do not use any abrasive cleaners.
FR	Le nettoyage se fait uniquement à l'aide d'un torchon ou d'une serviette légèrement mouillée.
NL	Reinig alleen met een stofdoek of een lichtjes vochtige doek. Gebruik geen schurende poetsmiddelen.
IT	Pulire esclusivamente con un panno o un asciugamano umido.
HU	A tisztítás kizárólag törölközővel vagy enyhén nedvesített törölközővel véggezhető. Súroló hatású tisztítószereket nem szabad használni.
RU	Чистите от пыли тряпкой или слегка влажной ветошью. Не допускаются применение чистящих средств, не предназначенных для ухода за мебелью.
RO	Curățați trebuie efectuată numai cu o cârpă sau cu un prosop umezit. Nu utilizați agenți de curățare abrazivi.
SK	Čistenie je nutné vykonať výhradne pomocou utierky alebo ľahko zvlhnutým ručníkom. Nepoužívajte čistiace prostriedky obsahujúci abrazívni častice.
TR	Lütfen sadece bir toz bezilye veya hafif nemli yumuşak bir bezle siliniz. Aşındırıcı temizlik mazeremeleri kullanmayınız.

PL	Mocowanie do ściany jest konieczne! Nie zabezpieczaniem przed przewróceniem - koniecznie zamontować! Do niektórych rodzajów ścian konieczne zastosować specjalne kołki mocujące.
CZ	Montáž na stěnu slouží jako ochrana proti převrnutí - bezpodminečně umístěte! U některých typů stěn může být zapotřebí speciální hmoždinky!
DE	Wandbefestigung dient als Kippschutz - unbedingt anbringen! Bei einigen Wandtypen kann ein Spezialdübel erforderlich sein!
GB	The wall fastening serves to prevent tipping - be absolutely sure to mount it! For certain wall types, a special wall plug may be necessary!
FR	La fixation murale sert de protection contre le basculement - à installer impérativement! Pour certains types de murs il faut des chevilles spéciales!
NL	Bevestiging aan de muur dient als kantelbescherming - zeker en vast bevestigen! Bij enkele muurtypes is een speciale plug misschien vereist!
IT	Il fissaggio alla parete serve da protezione anti-ribaltamento-attaccarla assolutamente! Per alcune strutture di parete può essere necessario un tassello speciale!
HU	A terméket a falhoz kell rögzíteni, külsőben az felborulhat! Egyes falípusoknál speciális típusú köll kell használni!
RU	Обязательно установите крепление на стене во избежание опрокидывания! Для некоторых типов стен может потребоваться специальный дюбель!
RO	Sistemul de fixare la perete serve ca protecție la răsturnare - de montat obligatoriu! Pentru unele tipuri de pereți este posibil să fie necesar un diblu special!
SK	Upevanie na stenu slúži ako ochrana proti prevráteniu - bezpodmienečne použite! Pre niektoré dĺhlny stien môže byť potrebná špeciálna hmoždinka!
TR	Duvardaki sabitleme, devrilmeye karşı bir emniyet tedbididir ve mutlaka monte edilmelidir! Bazı duvar tiplerinde bunun için özel bir dübel gereklidir!

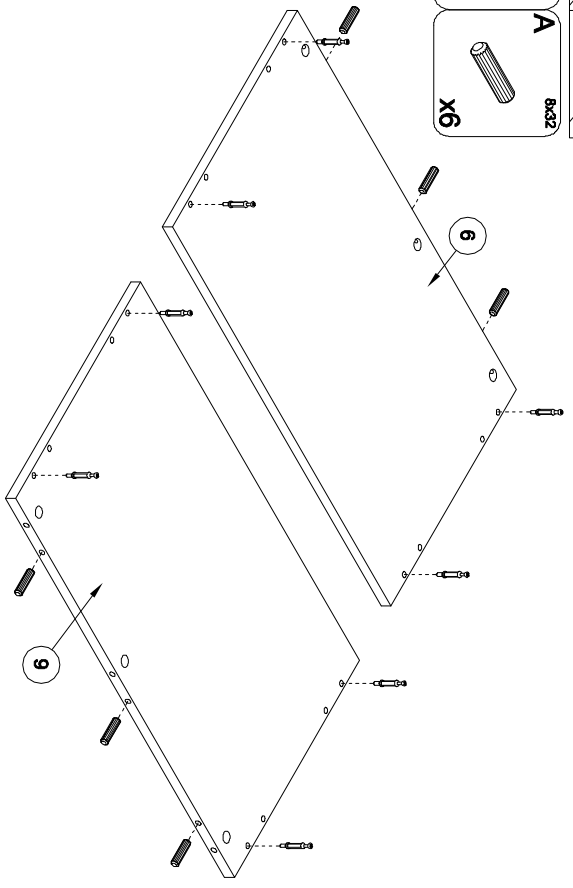
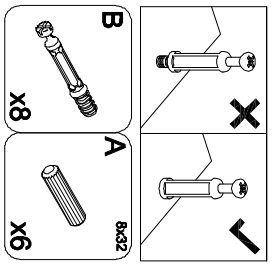

1

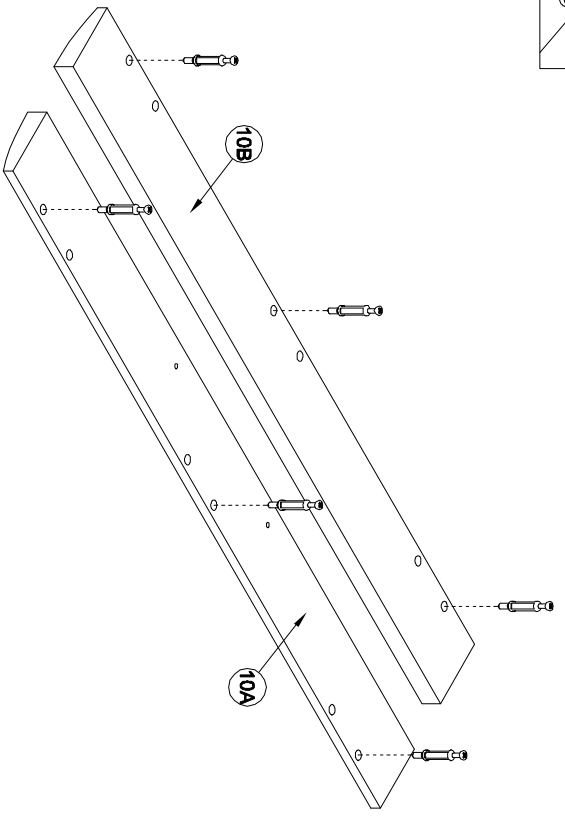
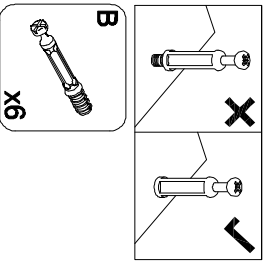

2

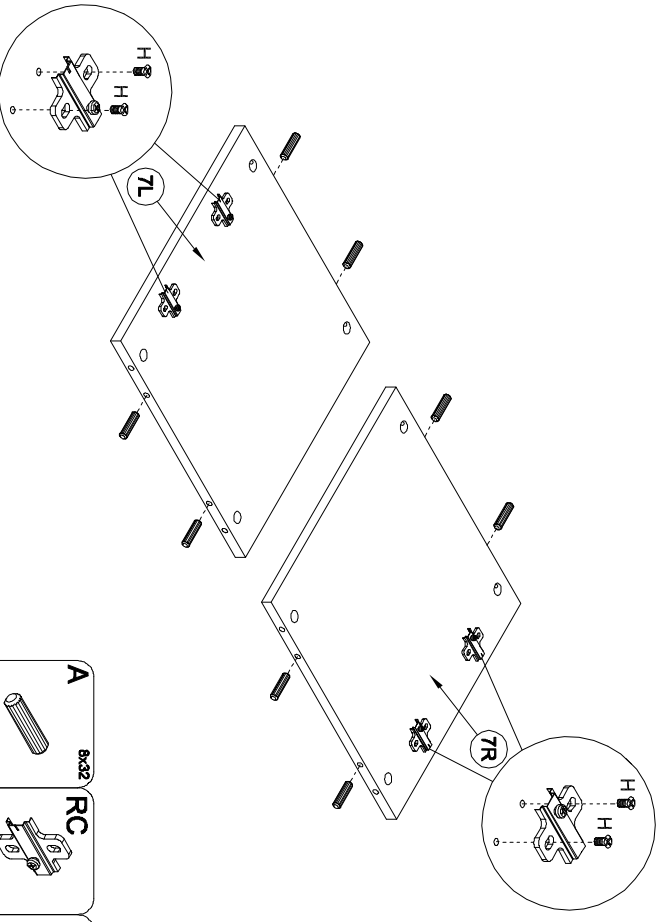

3

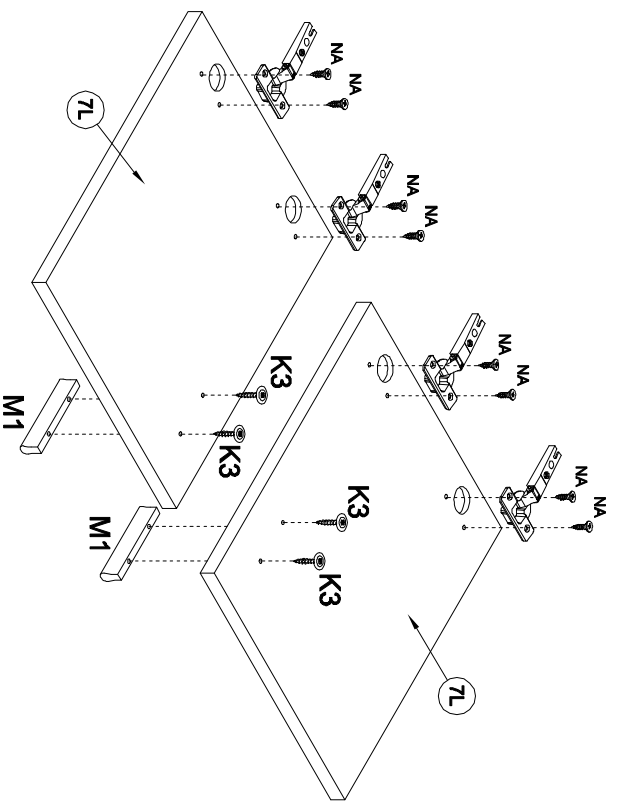
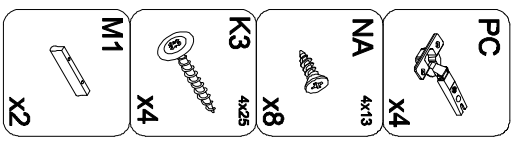
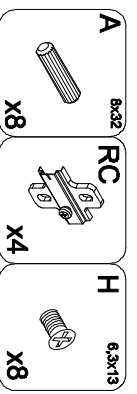

4

5

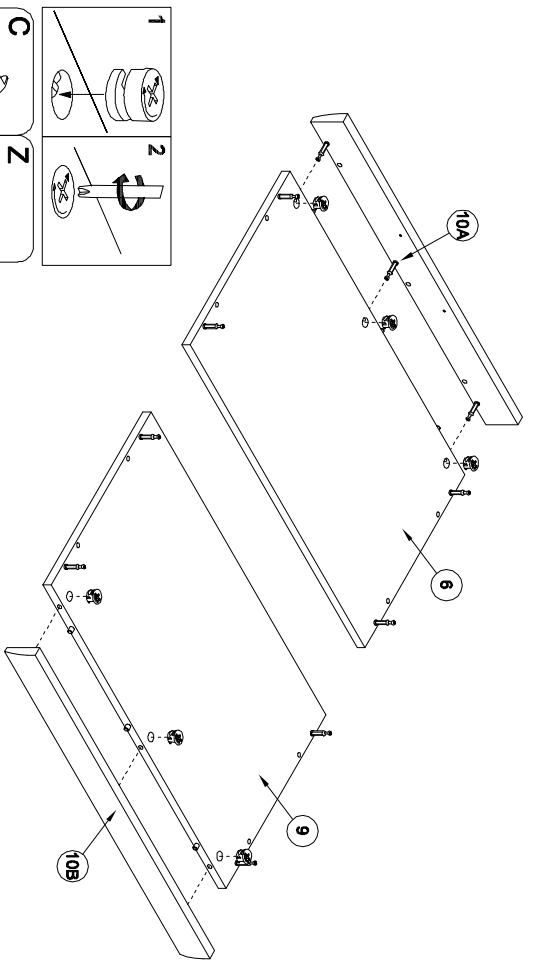

- | | |
|----|--|
| 1 | |
| 2 | |
| C | |
| X3 | |
| Z | |
| X3 | |

7

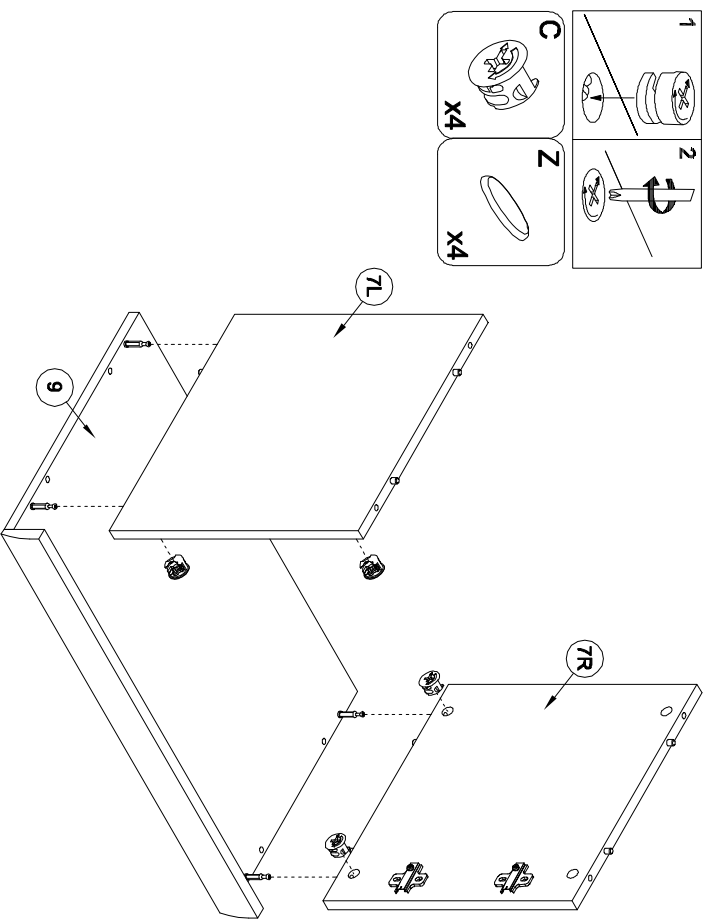

- | | |
|----|--|
| 1 | |
| 2 | |
| C | |
| X4 | |
| Z | |
| X4 | |

6

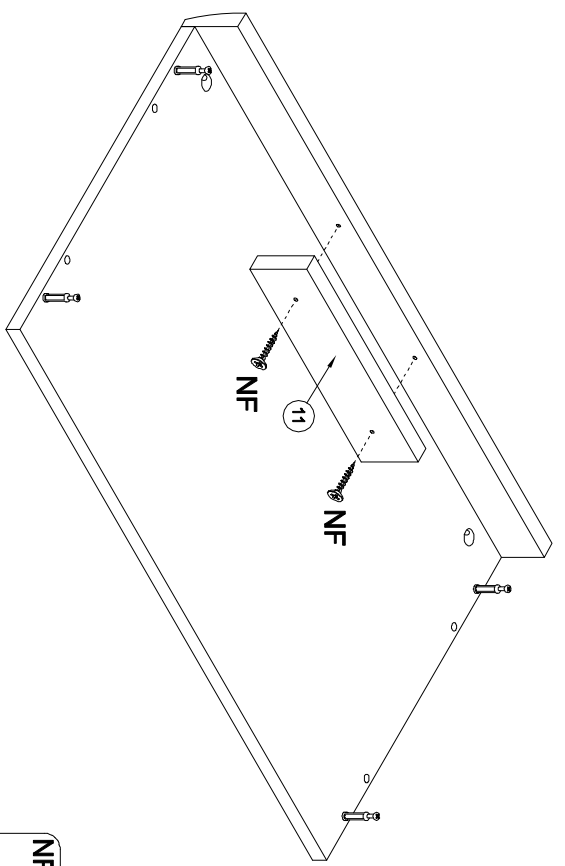

- | | |
|------|--|
| NF | |
| 4x30 | |
| X2 | |

8

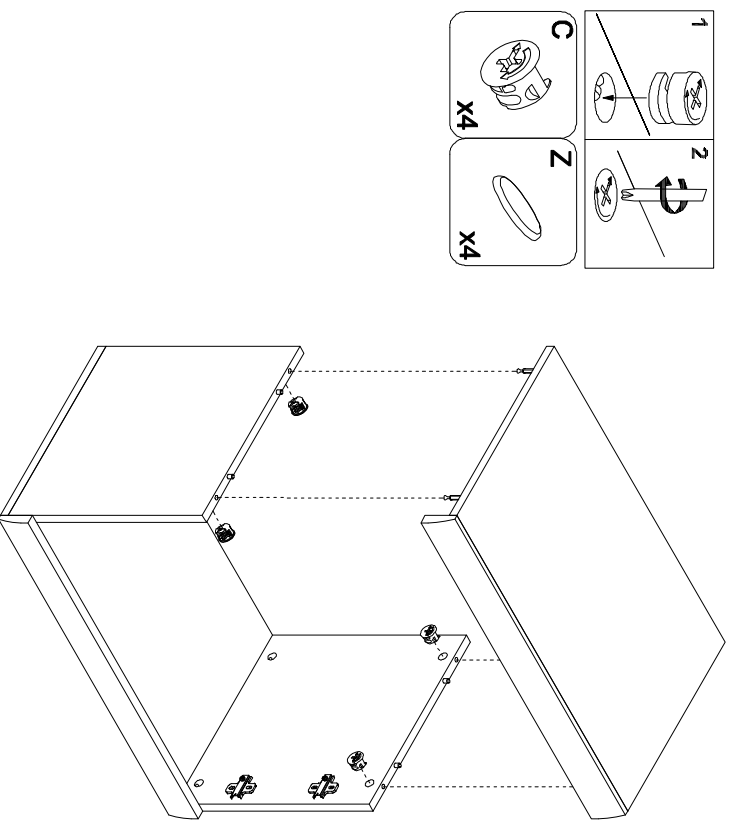

- | | |
|----|--|
| 1 | |
| 2 | |
| C | |
| X4 | |
| Z | |
| X4 | |

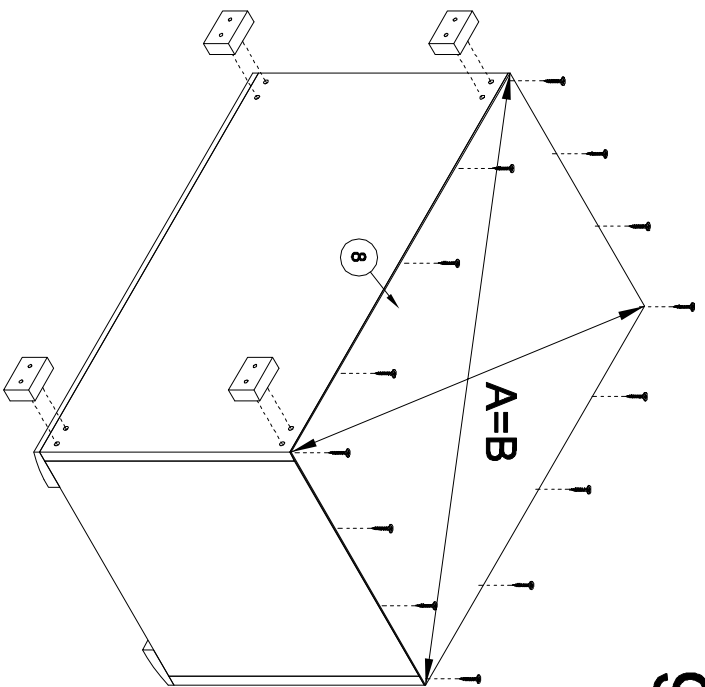
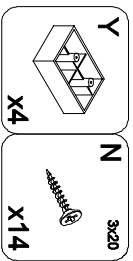
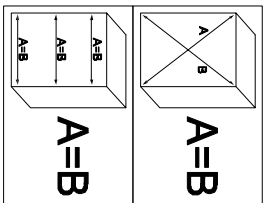

9

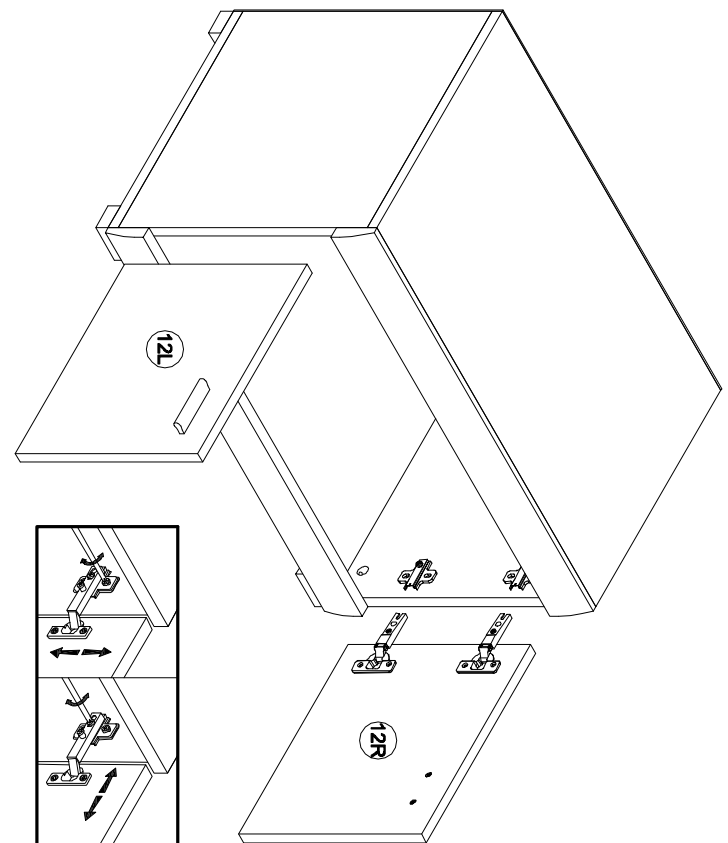

10

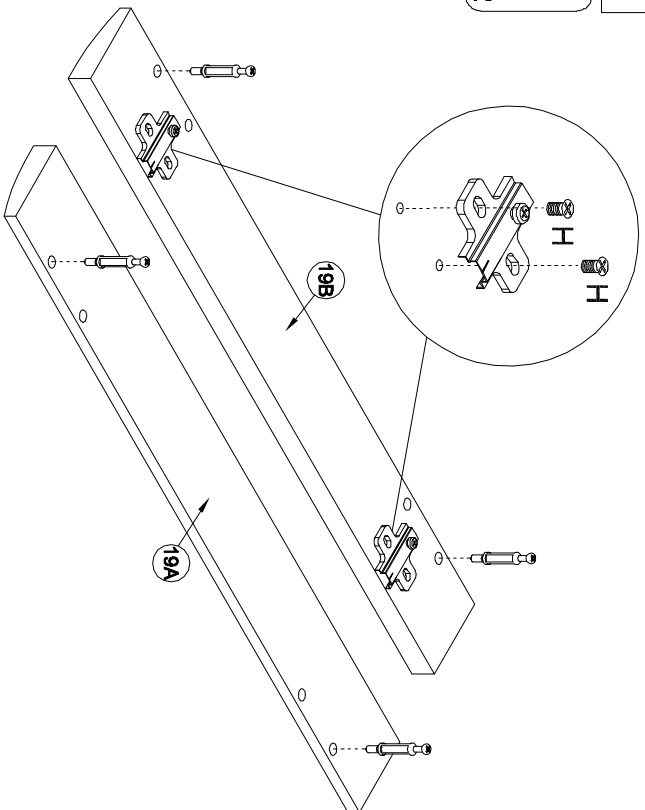
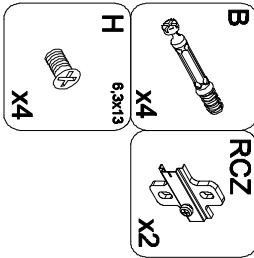
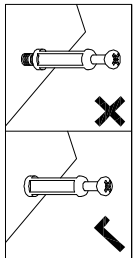
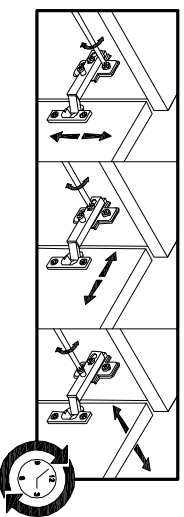

11

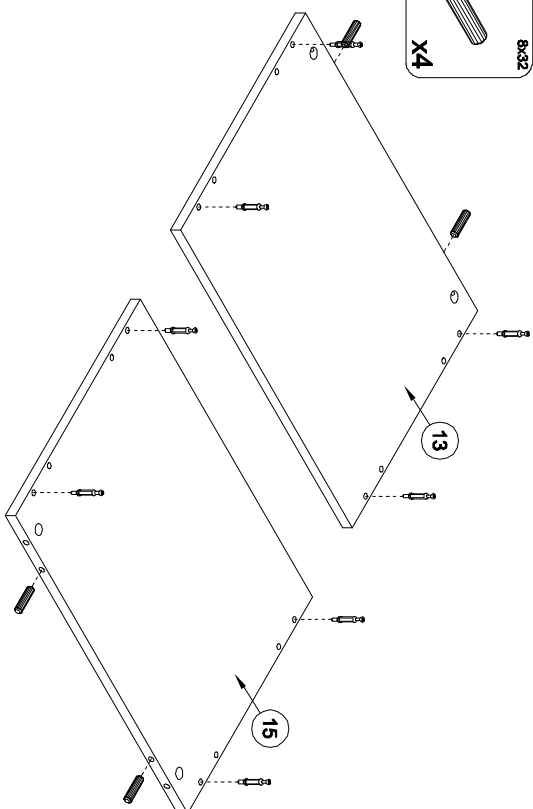
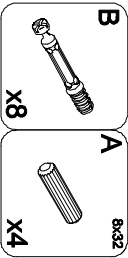
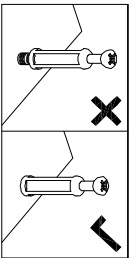

12

13

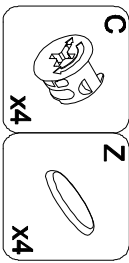
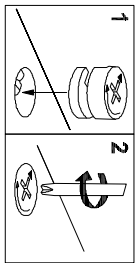
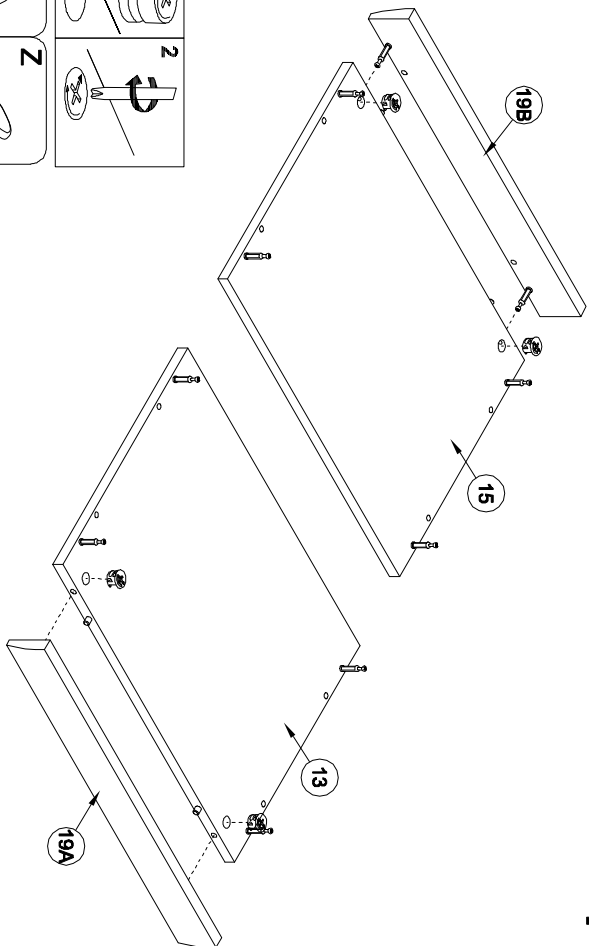

14

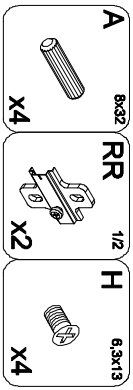
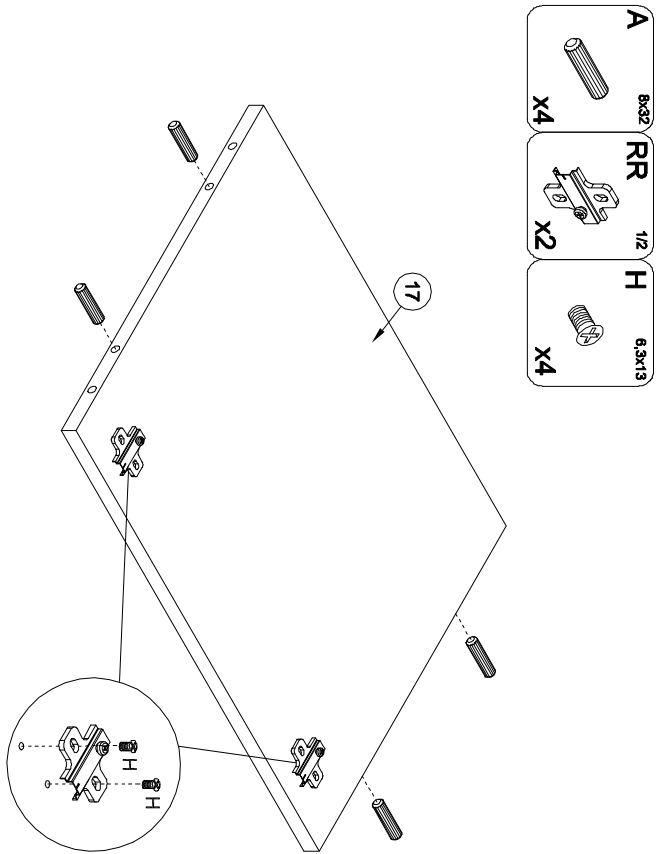

15

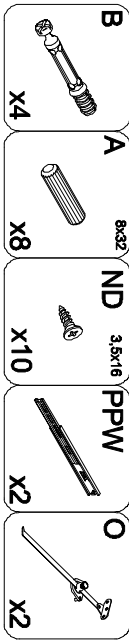
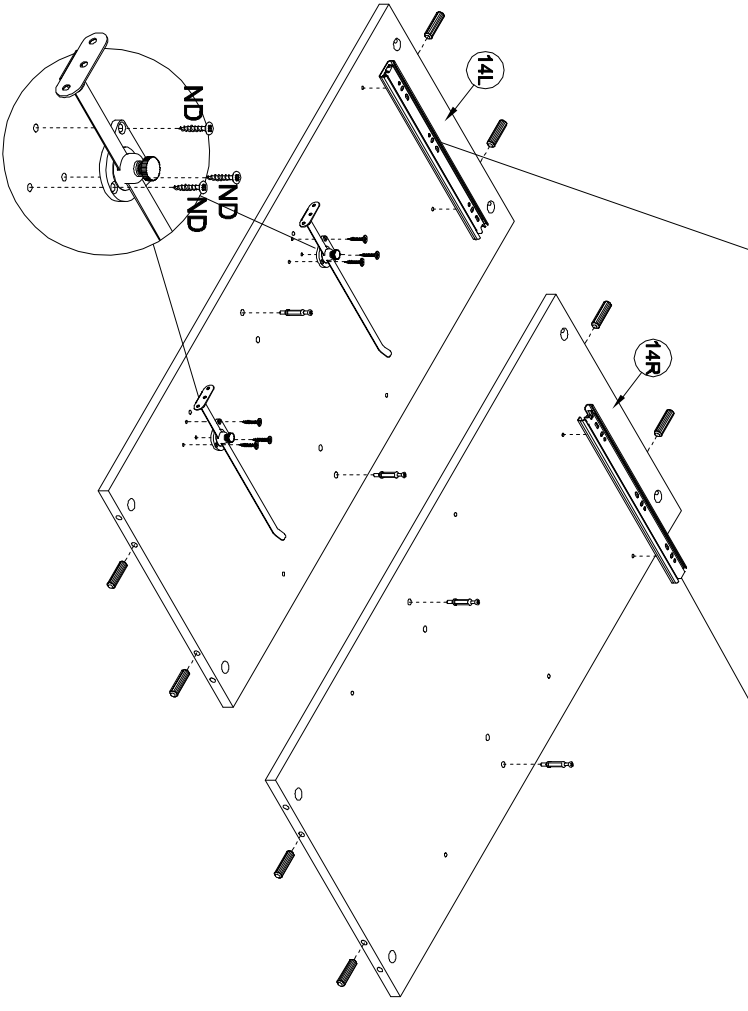
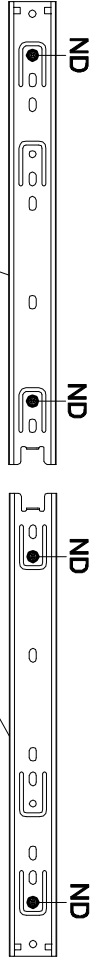
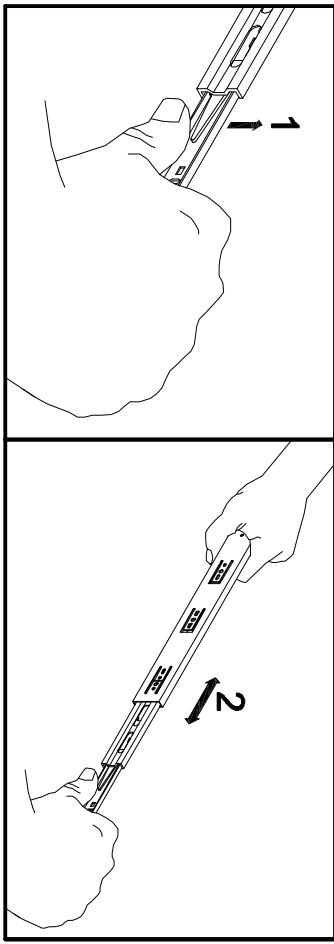

16

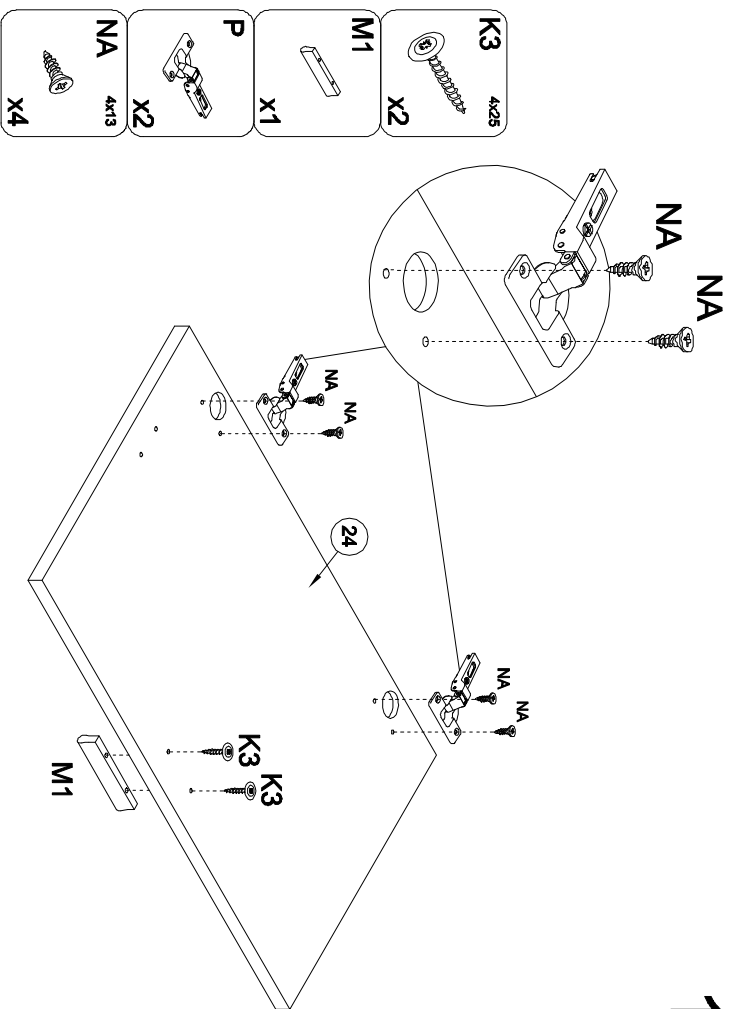

- K3** 4x25 X2
- M1** X1
- P** X2
- NA** 4x13 X4

17

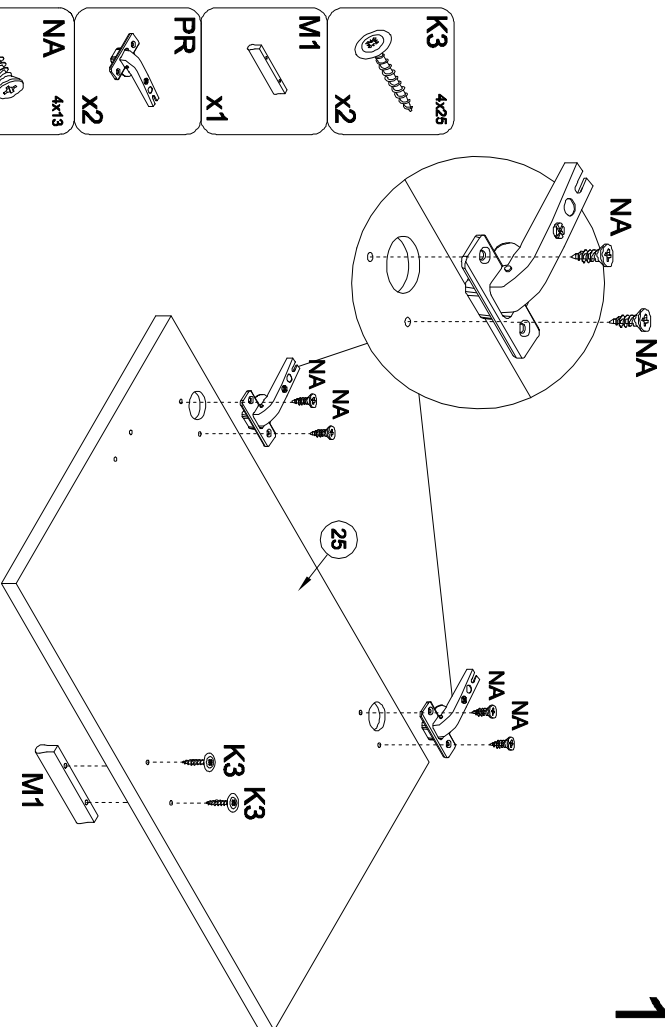

- K3** 4x25 X2
- M1** X1
- PR** X2
- NA** 4x13 X4

18

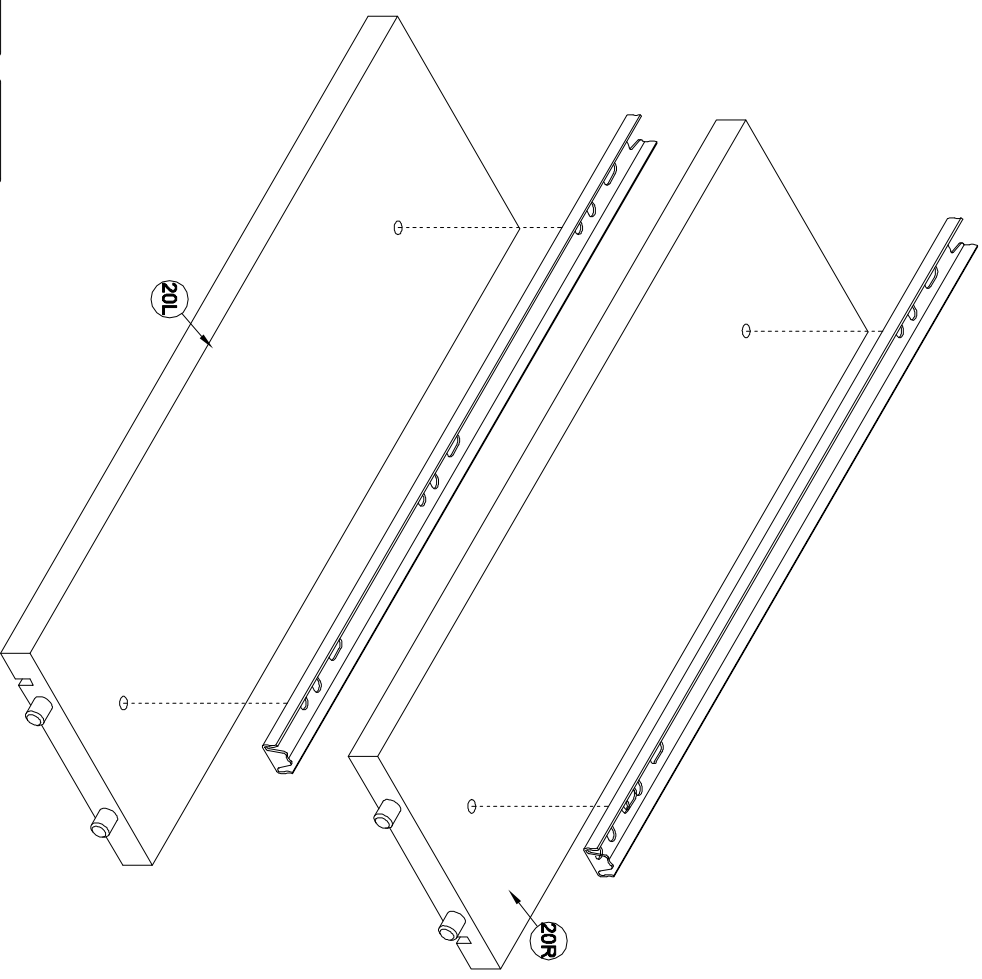
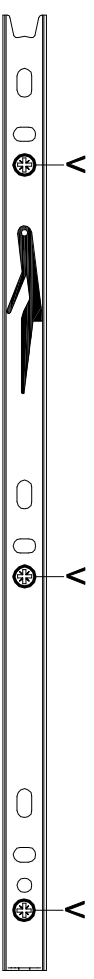

- V** 3x13 X6
- PPW** X2

19

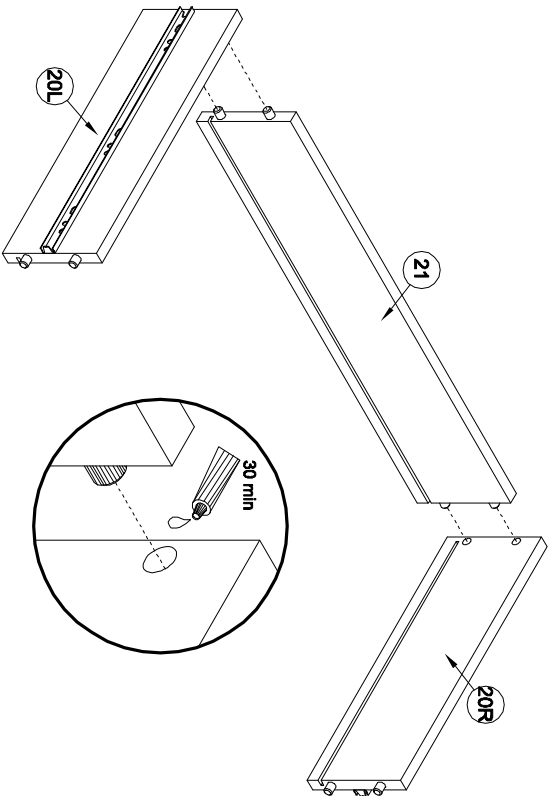

20

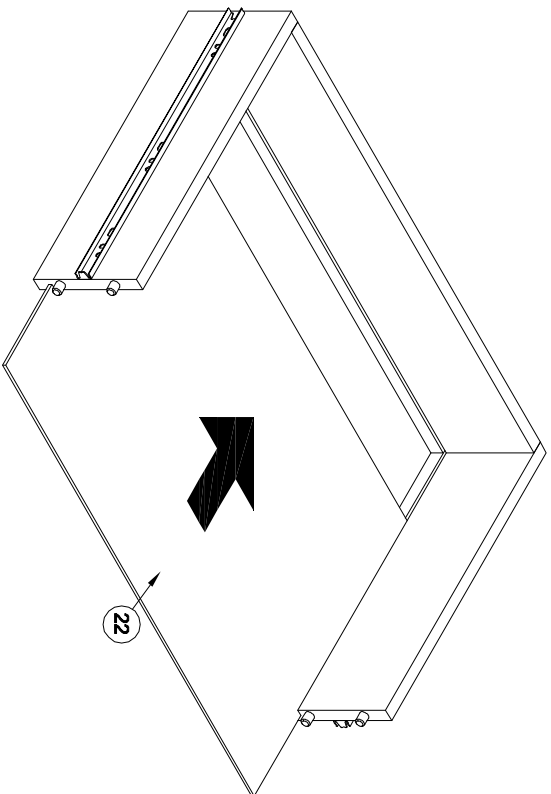

21

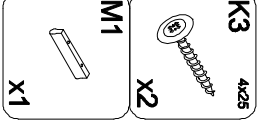
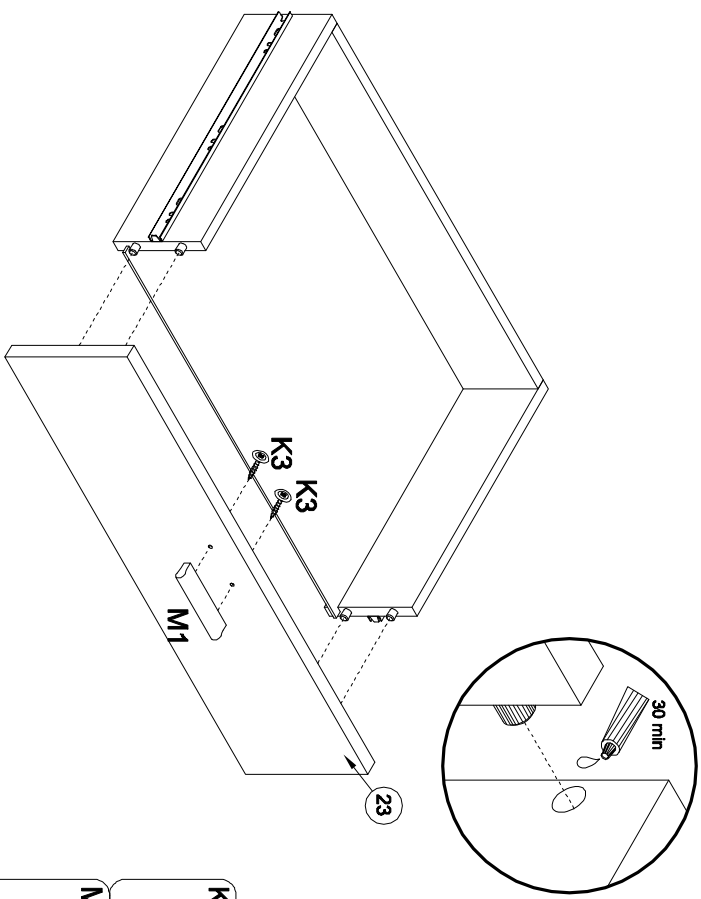

22

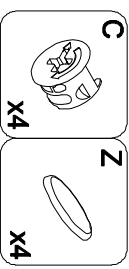
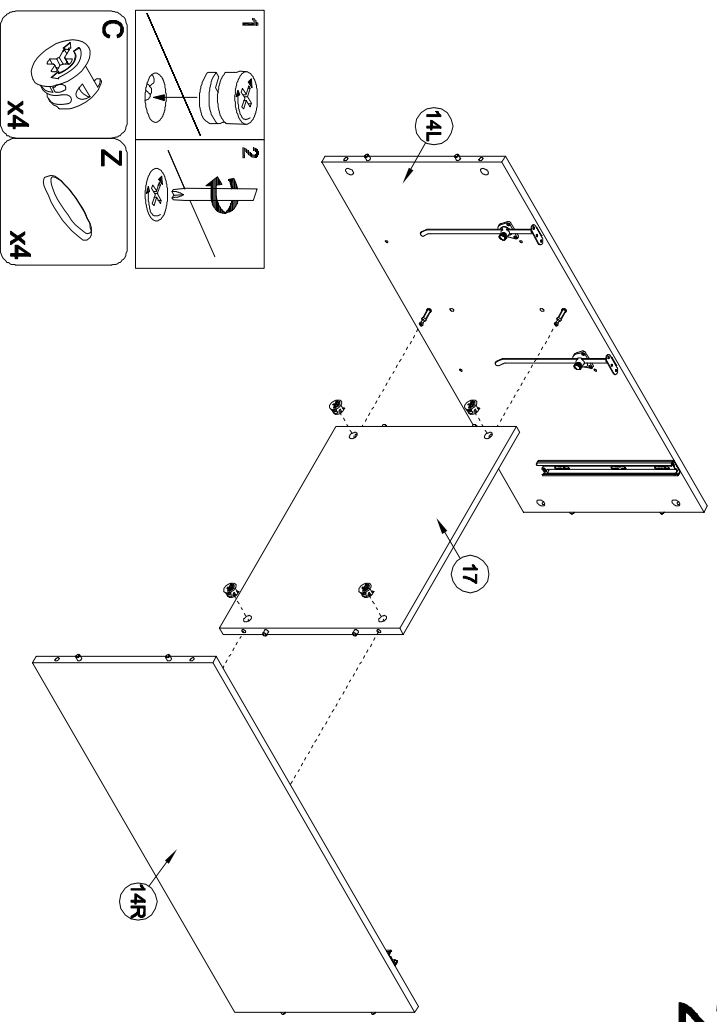

23

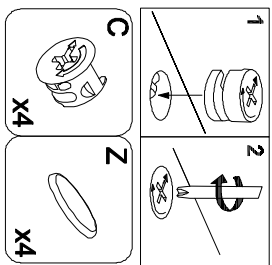
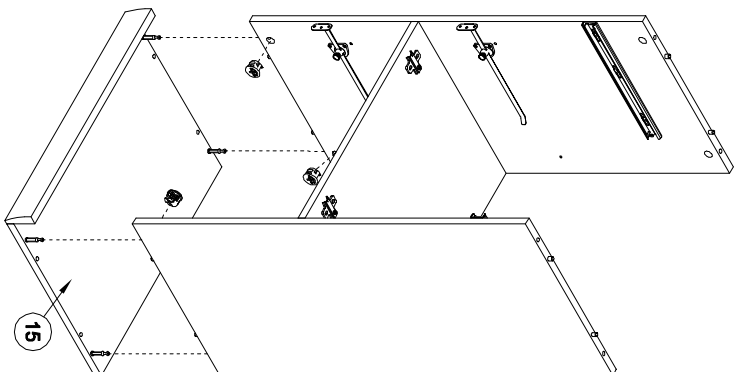

25

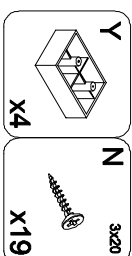
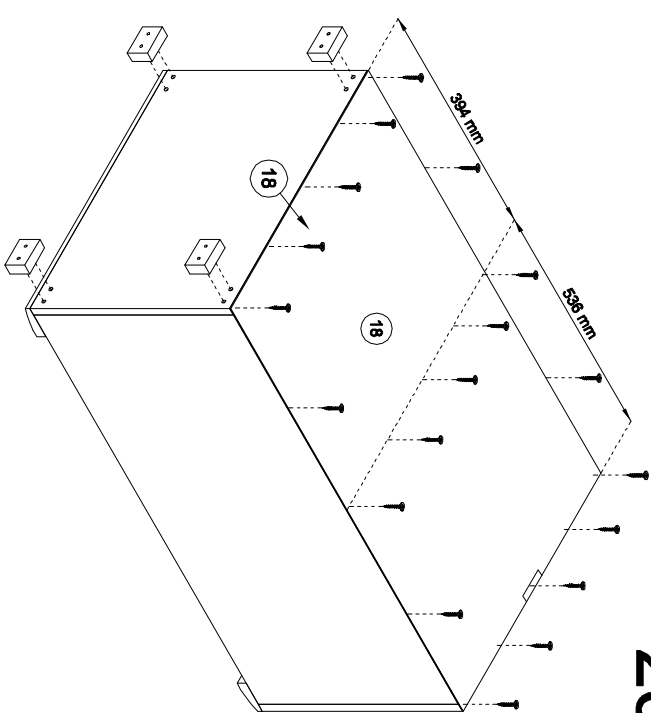

24

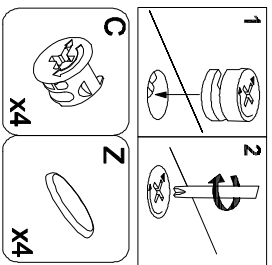
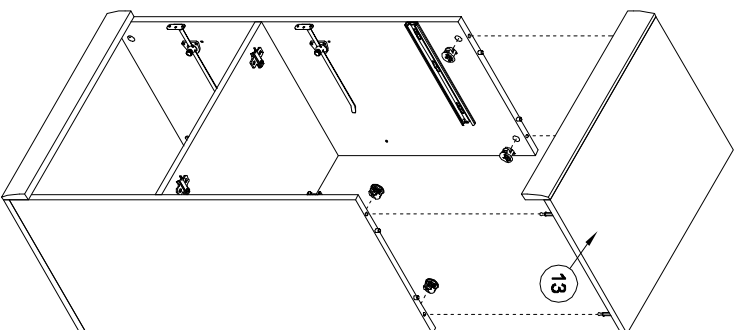

26

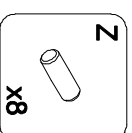
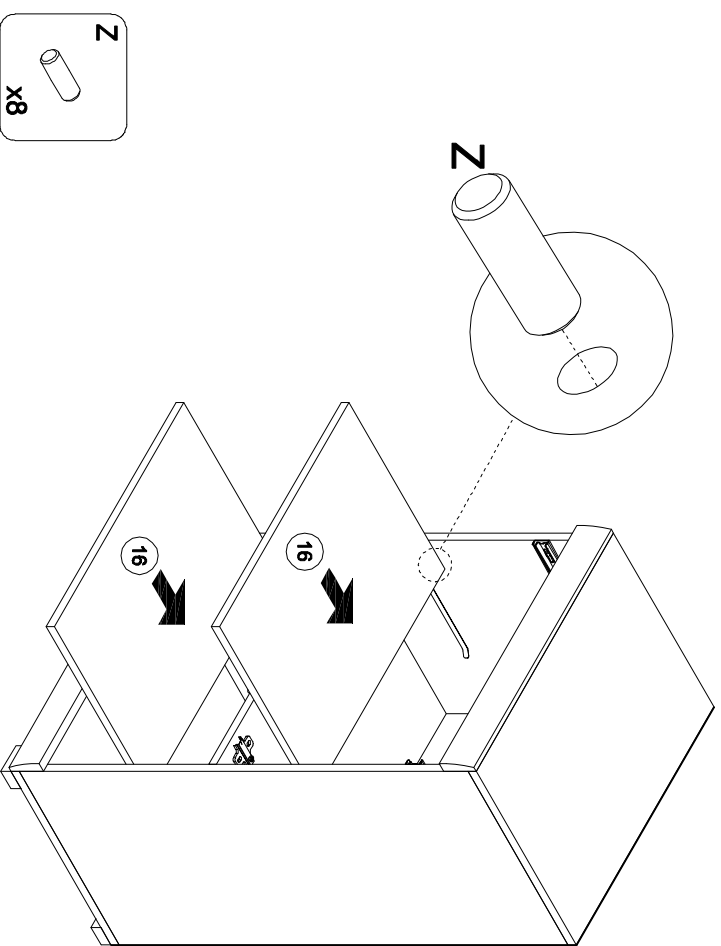

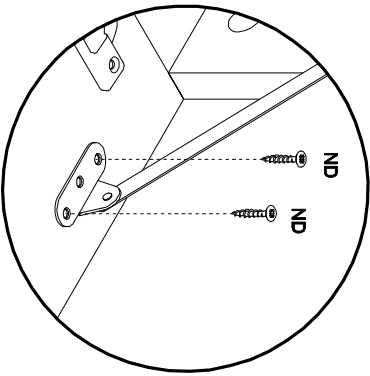
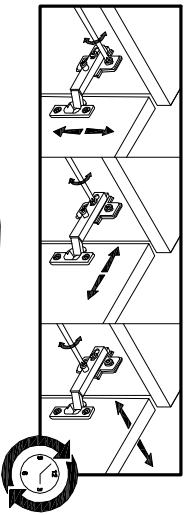

ND
3,5x16
x4

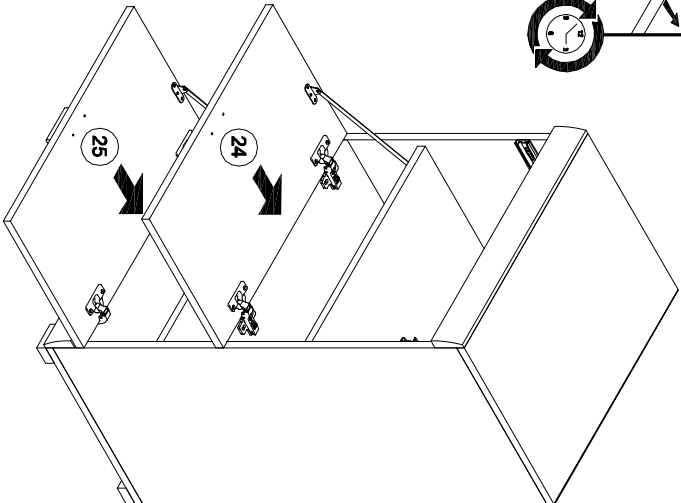

27

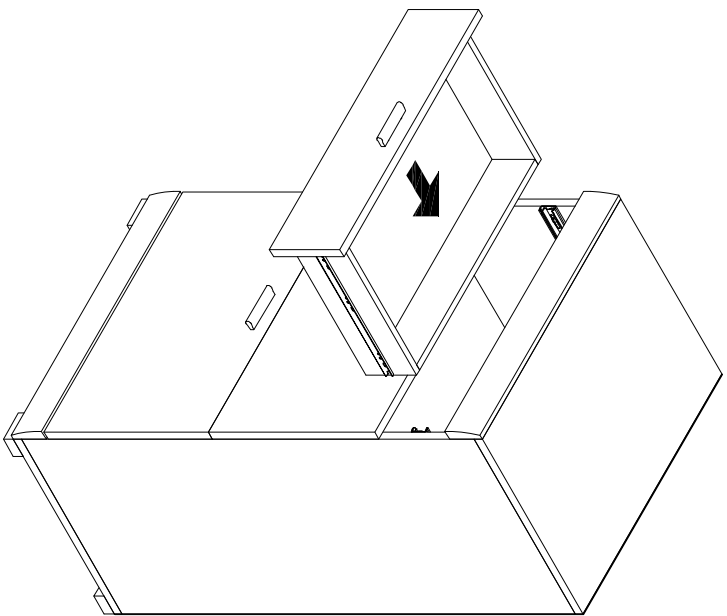

28

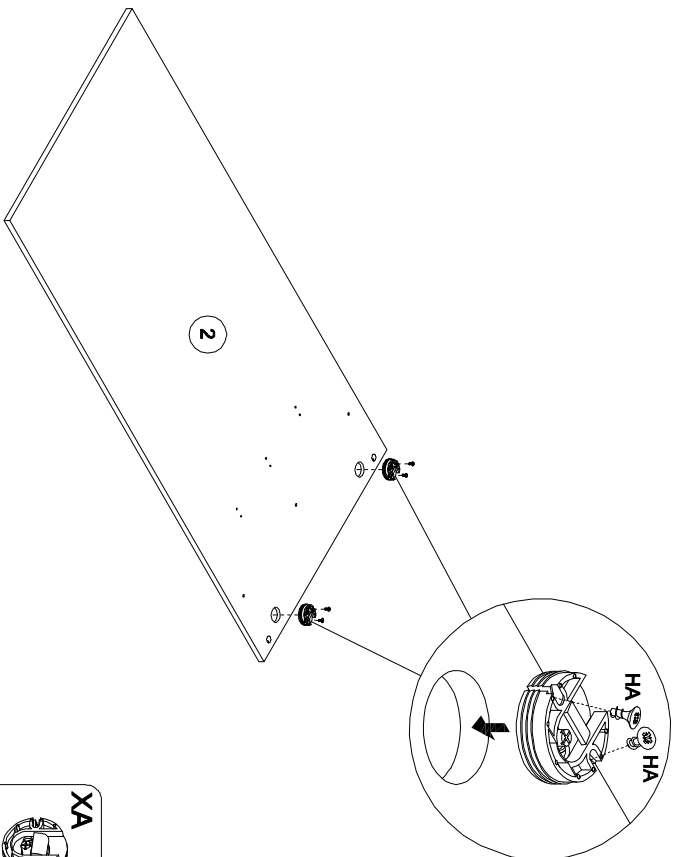

XA
X2
HA
5x9
X4

29

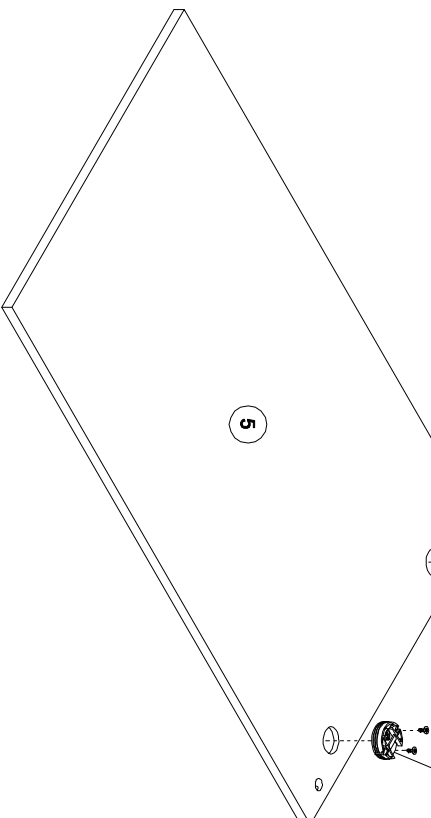
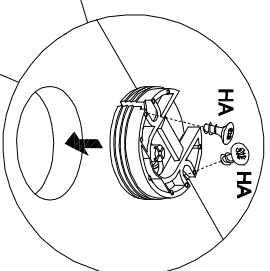
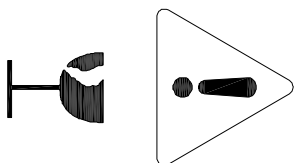

XA
X2
HA
5x9
X4

30

31

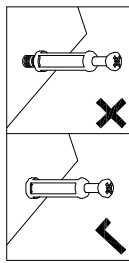
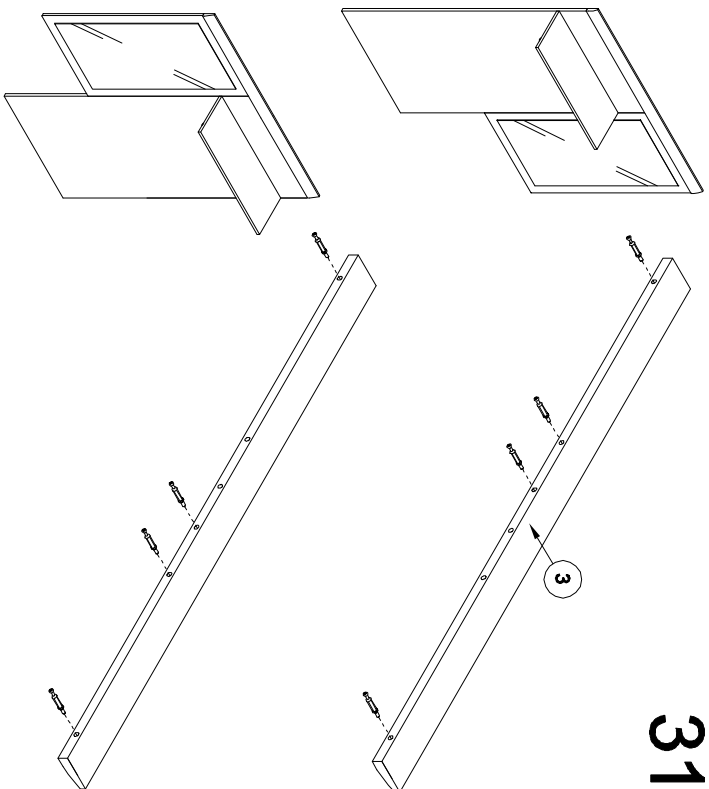

32

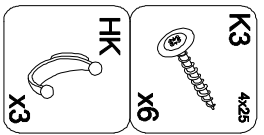
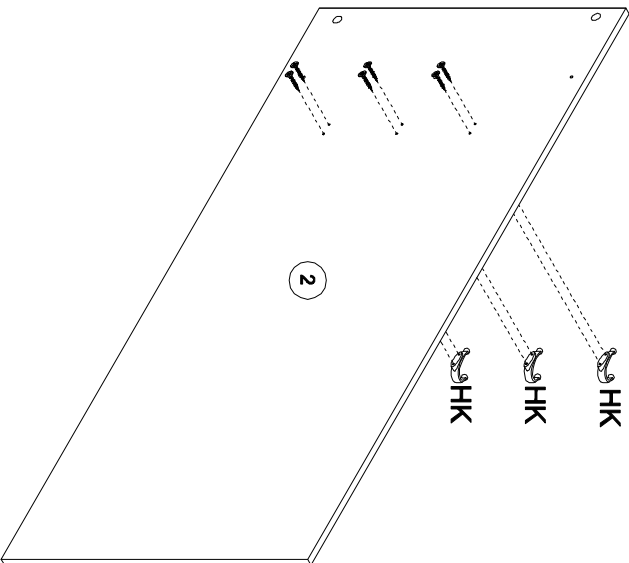

33

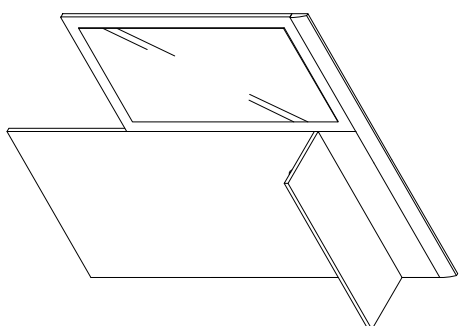
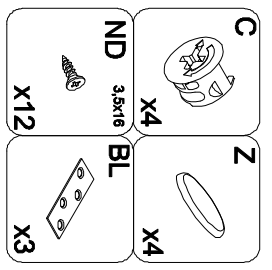
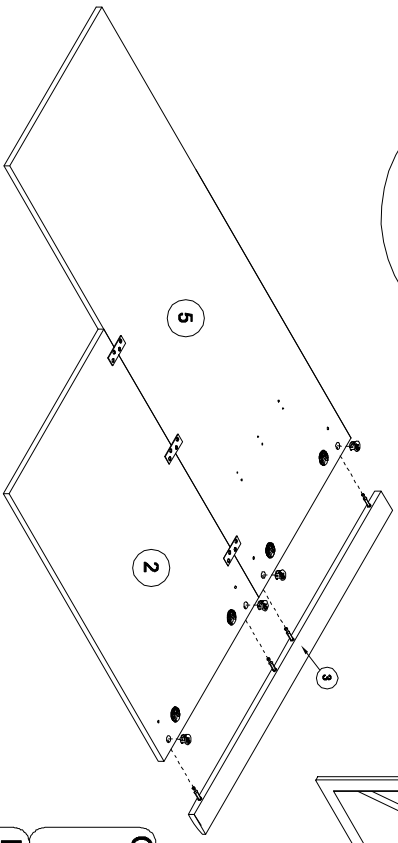
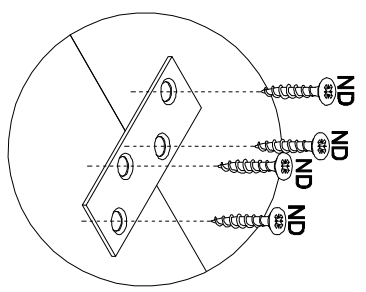
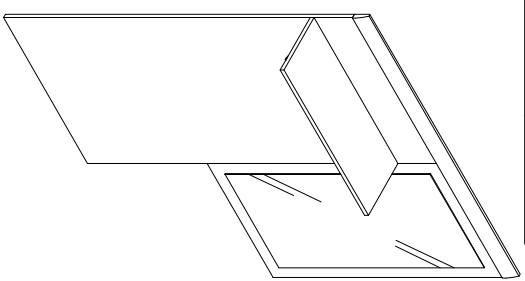
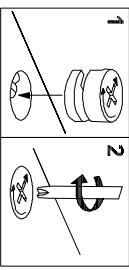

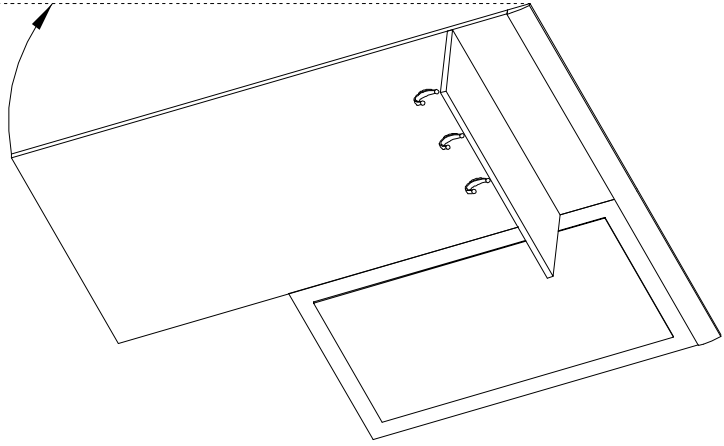
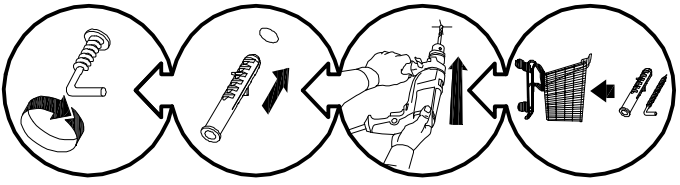

35

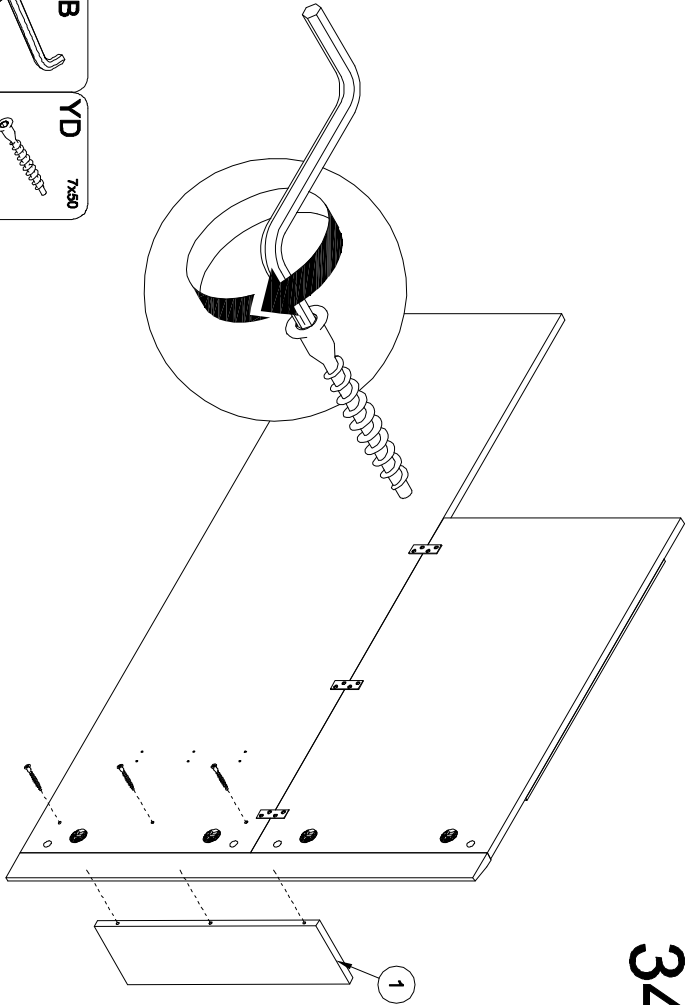
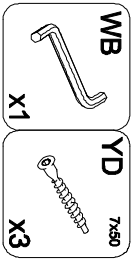

34

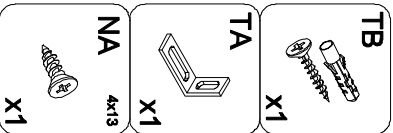
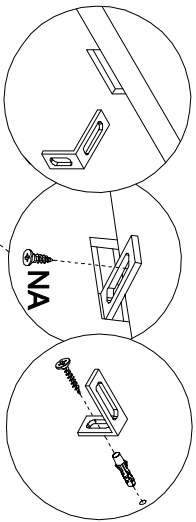
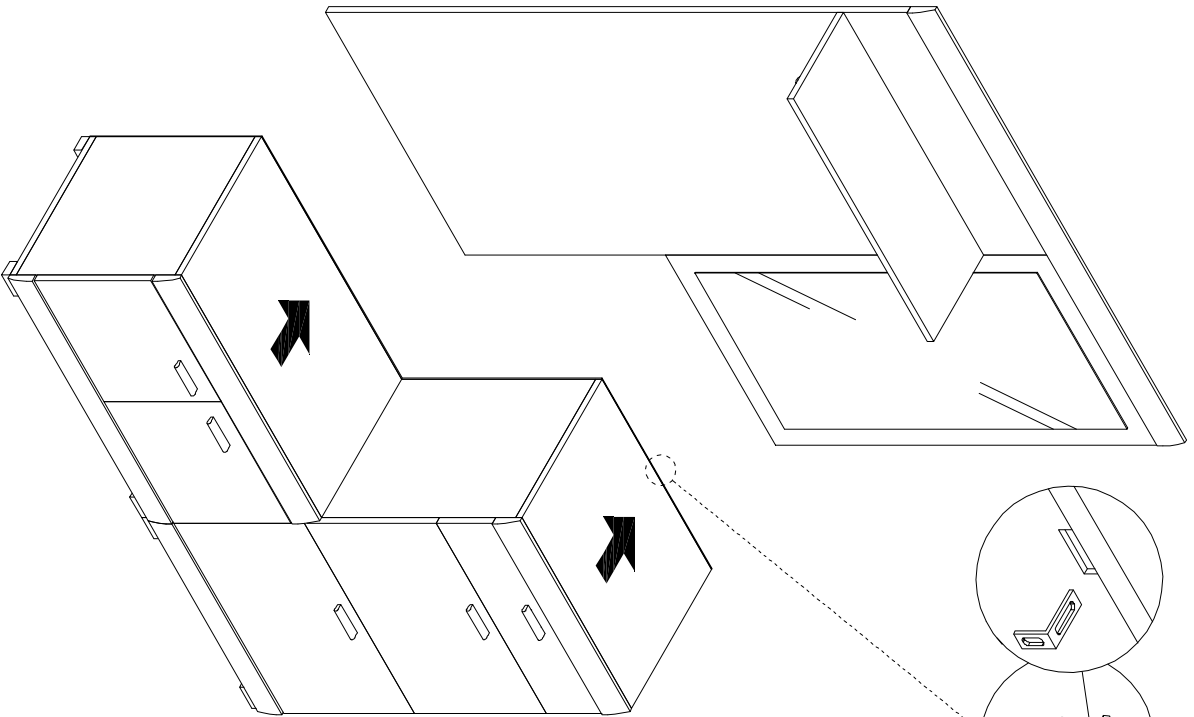

36